

Driving Directions to Fields

Fields

U-9 and U-10 teams play on the soccer fields located behind the High School.

U-11 teams play on the fields located in front of the Middle School.

U-12, U-13 and U-14 teams play on the field northeast of the Middle School.

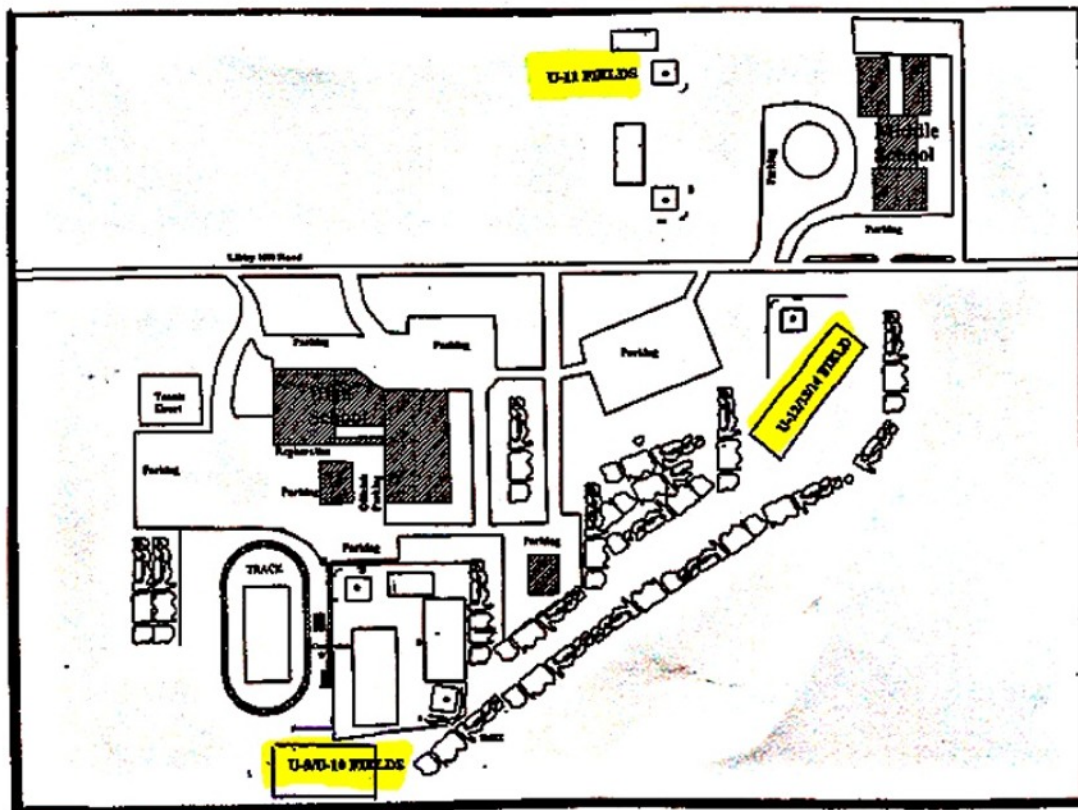

From the Maine Turnpike

Take the Maine Turnpike to exit 63. After exiting turnpike, take a right onto Route 202. Get into left lane of Rt. 202 and take left at next lighted intersection. Not more than 200 feet is a second set of lights. Take left onto route 26. Continue northerly on Rt. 26 for approximately 1.5 miles. When the road widens to three lanes get into left lane (a turning lane for the schools). Take a left turn onto Libby Hill Road. Gray/New Gloucester High School is approximately .1 miles on the right and the Middle School is located at the end of Libby Road.

From 202/100(westerly) – Lewiston / Auburn

Take route 202 into Gray. Stay in right lane and take right at first light onto Route 26. Continue northerly on Rt. 26 for approximately 1.5 miles. When the road widens to three lanes get into left lane (a turning lane for the schools). Take a left turn onto Libby Hill Road. Gray/New Gloucester High School is approximately .1 miles on the right and the Middle School is located at the end of Libby Road.

From 100/26(northerly)- Portland

Take 100/26 into Gray. Go straight through first set of lights and merge into the left lane after the lights. Not more than 200 feet is a second set of lights. Take left onto route 26. Continue northerly on Rt. 26 for approximately 1.5 miles. When the road widens to three lanes get into left lane (a turning lane for the schools). Take a left turn onto Libby Hill Road. Gray/New Gloucester High School is approximately .1 miles on the right and the Middle School is located at the end of Libby Road.